

CROWN

TC 3000

Series

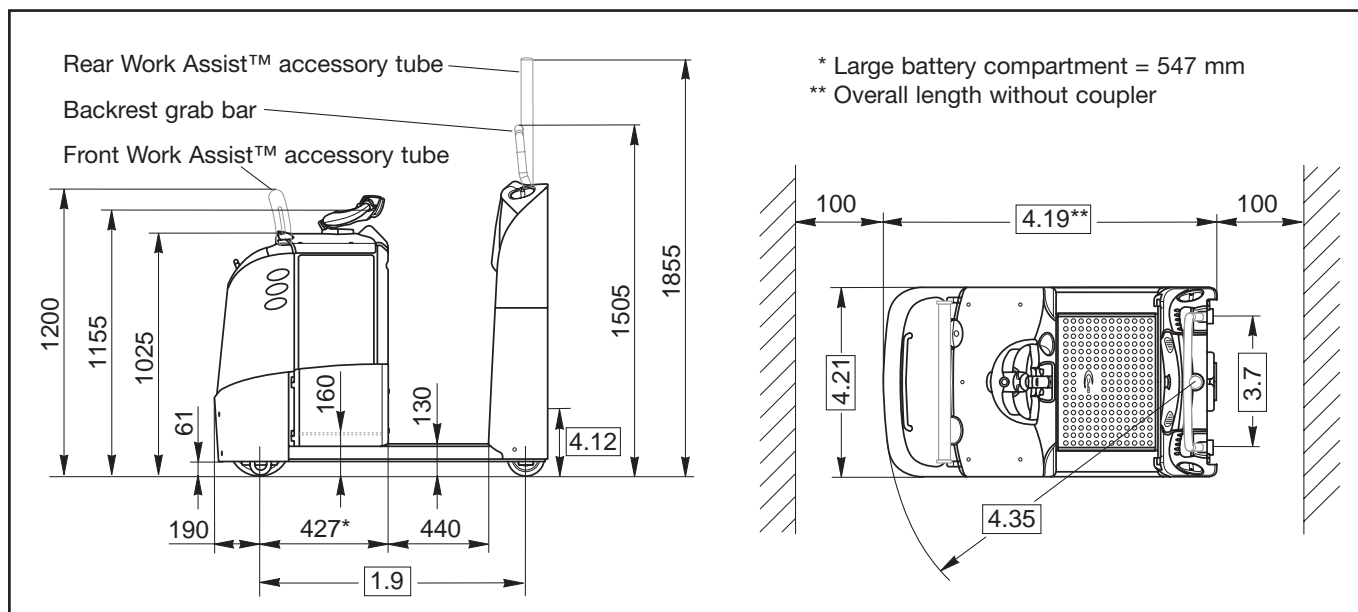



General Information	1.1	Manufacturer	Crown Equipment Corporation			
	1.2	Model	TC 3000-3.0			
	1.3	Power	electric			
	1.4	Operator Type	stand-on			
	1.5	Load Capacity	Q	kg	3000	
	1.7	Rated Drawbar Pull	F	N	800	
	1.9	Wheel Base	y	mm	1030	1150
Weights	2.1	Weight	less battery	kg	590	630
	2.2	Axle Load	without load, front / rear	kg	595 / 380	690 / 440
Tyres	3.1	Tyre Type	Vulkollan			
	3.2	Wheel Size	front	mm	Ø 250 x 75	
	3.3	Wheel Size	rear	mm	Ø 150 x 60	
	3.4	Additional Wheels	optional	mm	Ø 60 x 82	
	3.5	Wheels	number (x=driven) front/rear	1x / 2		
	3.6	Track Width	front	b10	mm	central position
	3.7	Track Width	rear	b11	mm	563
Dimensions	4.8	Operator Stand Height	h7	mm	130	
	4.9	Tiller Arm Height	h14	mm	1155	
	4.12	Coupler Height	h10	mm	see couplers	
	4.19	Overall Length	without coupler	l1	mm	1310 1430
	4.21	Overall Width		b1	mm	810
	4.32	Ground Clearance	centre wheelbase	m2	mm	61
	4.35	Turning Radius		Wa	mm	1220 1340
Performance	5.1	Travel Speed	w. / w.o. load	km/h	8.5 / 12.5	8.0 / 12.5
	5.6	Max. Drawbar Pull		N	3250	
	5.7	Gradeability		%	see diagram	
	5.10	Service Brake			electric	
Motors	6.1	Traction Motor	rating at S2 60 min.	kW	2.5	
	6.3	Max. Battery Box Size		lxwxh	mm	210x790x784 330x790x784
	6.4	Battery Voltage	nominal capacity K5	V/Ah	24/420,465 24/560,620	
	6.5	Battery Weight		kg	367,383	489,509
	8.1	Type Controller	drive		transistor	

Coupler Heights min./max.

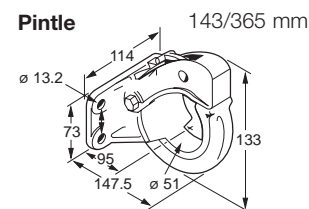
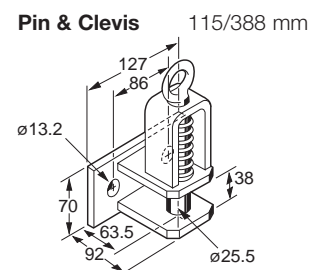
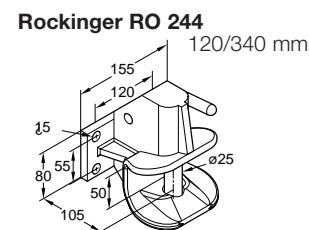
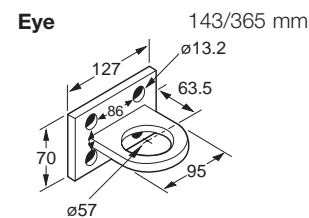
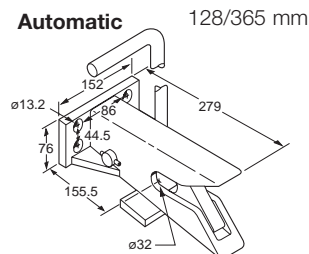

Mounting plate allows all types of couplers to be adjusted in 45 mm increments (Rockinger RO 244 in 55 mm increments)

Gradeability diagram TC 3000

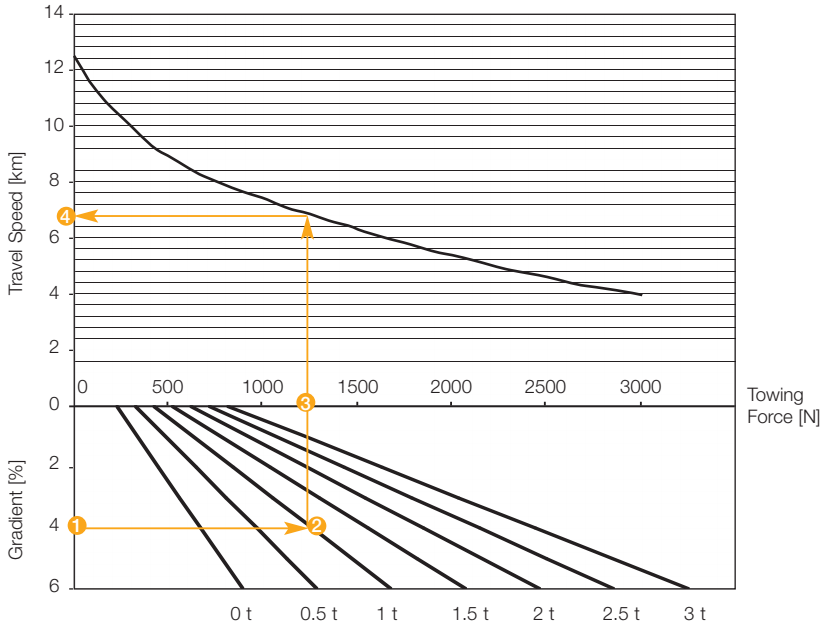

- The example shows that at a gradient of 4% ① with a load of 1 ton ② the TC 3000 has to apply 1250 N ③ towing force and will achieve a travel speed of 6.8 km/h. ④
- Maximum continuous towing force is 800 N.
- Trailers with a braking system are recommended for gradients more than 4 %.

Electric System / Batteries

24-volt electrical system with nominal battery capacities from 420 Ah up to 620 Ah. The battery can be removed vertically or horizontally with optional battery rollers for left/right or both sides removal.

Standard Equipment

- Maintenance free 3-phase (AC) traction and steering motors
- e-Gen™ Braking System offers regenerative and frictionless electric braking (Mechanical braking applies only as parking brake)
- Electronic steering with the centre mounted X10® Handle for precise and effortless control
- The self-centering X10® Control Handle places all truck functions at the operator's fingertips
- Crown Access 1 2 3™ Comprehensive System Control
- Intelligent Steering System slows the travel speed in curves
- Crown's Information Display
 - 1 line LCD display with 8 characters
 - Battery discharge indicator
 - Keyless start up with PIN code
 - Start up and run time diagnostics
 - 3 selectable traction performance profiles
 - Hour meters including traction motor and run time
 - Access 1 2 3 onboard diagnostic with real time troubleshooting capabilities
- CAN-Bus technology
- Ramp hold
- Low step height of 130 mm with a wide walk-through area
- Suspended floorboard with a non-slip anti-fatigue floor mat with integrated presence sensors
- Electric power disconnect plug

- Large storage compartments
 - Large front storage tray
 - Large storage compartments in the backrest
 - 2 large storage bins in the backrest
- Vulkollan drive tyre and load wheels with additional rounded skid bars
- Soft contoured backrest and cushioned soft kneepad
- Battery connector DIN 160 A
- Heavy duty power unit
 - 10 mm thick steel skirt
 - Easily removable reinforced steel covers
 - Top battery access

Optional Equipment

- Additional wheels Ø 60 x 82 mm instead of skid bars
- Backrest grab bar
- Adjustable fold-down lean seat
- Hitch Position Control™ in backrest
- Desktop work surface (with large battery compartment)
- Battery roll out for left / right or both sides
- SBE 160 red battery connector
- Power supply 12V for electronic tools
- Cold storage conditioning
- Front Work Assist™ accessory tube
- Rear Work Assist™ accessory tube
- Work Assist™ Accessories
 - Load tray
 - Foil roll holders
 - Storage pockets
 - Beverage holder
 - Trash bag holder
 - Scan gun holder
 - Small, medium and large clip boards
 - Mounting brackets for WMS terminals
- Rear storage compartment
- Audible travel alarm
- Flashing beacon
- Rubber bumper
- Key switch
- Key pad
- Special paint

Electrical

24 volt electrical system managed by Crown's Access 1 2 3 Comprehensive System Control. Virtually maintenance-free AC traction motor provides strong acceleration and control at any speed. Sensors monitor functional parameters including steering, speed and operator position and adjusts operational settings automatically to suit conditions.

Power Unit

The rugged power unit is designed for tough real-world applications. A 10 mm thick skirt protects drive unit and caster components while reinforced steel covers and doors cover all electronics. The uncluttered layout of components provides quick and easy access for servicing.

Operator Area and Controls

Soft and fully suspended floor-board reduces operator fatigue. Wide walk-through compartment with rounded surfaces provides a convenient shortcut even while carrying boxes. Contoured lean pad helps the operator stay centred in the truck while providing a soft contact surface to lean against. Multiple storage pockets provide locations for tools and personal effects. All truck functions are controlled by the award-winning X10 control handle that allows simultaneous operation of all functions with one hand. Electronic steering is standard, providing precise, predictable control. A large information display provides battery discharge level, operational status and service messages to the operator.

Access 1 2 3™ Comprehensive System Control

Crown's Access 1 2 3 technology provides optimum performance and control by offering a communications interface for the operator and service engineer, intelligent

coordination of truck systems and simplified service with advanced diagnostics.

The display includes a full featured on-board service tool so service engineers can actively view inputs and outputs during truck operation. No laptop or service terminal is required.

Performance tuning can be accessed at the display to customise truck performance for specific applications or operator requirements.

e-GEN™ Braking System

The power of the high-torque AC traction motor is used to stop the truck and keep it static until a travel input is requested, even when operating on a gradient. This system eliminates adjustments and wear points for a lifetime of maintenance free use. An automatic parking brake activates if the truck is stopped and the operator leaves the platform or power is disconnected.

Work Assist™ Accessories

A comprehensive range of Work Assist accessories are available to support every kind of picking and administrative task. These rugged tools can be easily combined and positioned in the location best suited to the application and the user. Customer accessories can also be added using the universal clamp and adapter plate.

Safety Regulations

Conforms to European safety standards. Dimensions and performance data given may vary due to manufacturing tolerances. Performance is based on an average size vehicle and is affected by weight, condition of truck, how it is equipped and the conditions of the operating area. Crown products and specifications are subject to change without notice.

Crown**European Headquarters**

Moosacher Strasse 52
80809 Munich
Germany

Tel +49(0)89-93002-0

Fax +49(0)89-93002-133

www.crown.com

Because Crown is continually improving its products, specifications are subject to change without notice.

Crown, the colour beige, the Momentum symbol, X10, The X10 Handle, the stylised X10 logo, Access 1 2 3 ™, e-Gen, Hitch Position Control, InfoPoint and Work Assist are trademarks of Crown Equipment Corporation.

Copyright 2007 Crown Equipment Corporation
TC 3000 BROCH GB 01/08, 25 – M01356-006-00
Printed in Germany

